

# SHIFT 4

**LBM.next nav**

August 2021

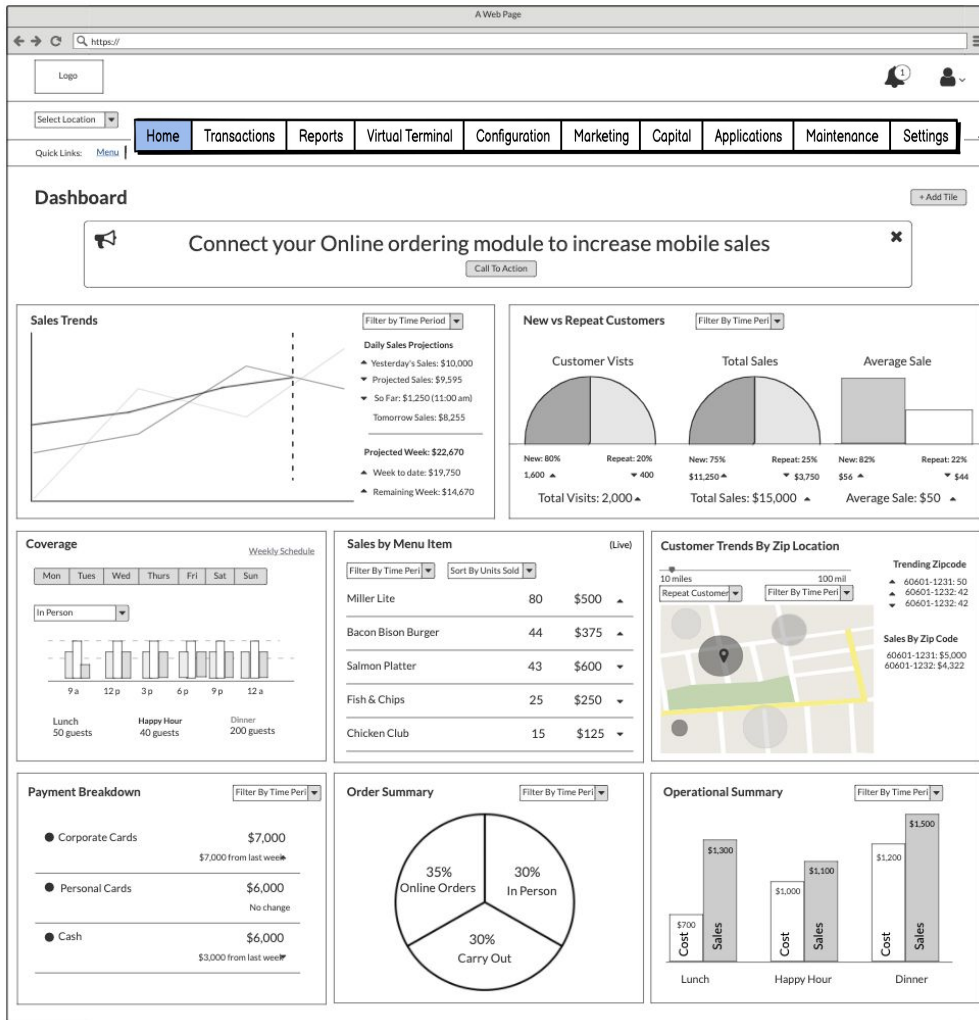

Updated Navigation Options

A Web Page

https://

Logo

Select Location

Home Transactions Reports Virtual Terminal Configuration Marketing Capital Applications Maintenance Settings

Quick Links: Menu

### Transaction Status

Back Print Export Update

Date presets: Select... Date Range: 5/1/2021 5/13/2021

Transaction Type	Invoice	Date	Card Type	Card Number	Customer Name	Amount	Fraud Score
Card Decline	<a href="#">AB-10987</a>	5/1/2021	Visa	479890****9009	Sharon Williams	\$24.99	▲ 55
Fraud Decline	<a href="#">AB-10986</a>	5/1/2021	American Express	823140****7845	Ron Sanford	\$94.99	▲ 92
Auth	<a href="#">AB-10985</a>	5/1/2021	Discover	475590****9999	Olive Rodrigo	\$65.99	● 12
Fraud Decline	<a href="#">AB-10984</a>	5/1/2021	Visa	488888****3421	Aaron Ryan	\$987.99	▲ 80
Card Decline	<a href="#">AB-10983</a>	5/1/2021	Visa	423890****9087	Chris Huett	\$19.99	▲ 65
Auth	<a href="#">AB-10982</a>	5/1/2021	Visa	474689****5674	Saul Williams	\$16.99	● 12

## Transactions:

- Real time transaction dashboard
- App was recently added to Shop, this page copied from that implementation
- Figma available [here](#)

A Web Page

https://

Logo

Select Location

Home Transactions **Reports** Virtual Terminal Configuration Marketing Capital Applications Maintenance Settings

Quick Links: Menu

## Reports

Duet 0021337406 - Duet Cafe

Select a Report: Activity Summary

Select a Period: 01/01/2021 4:00 AM - 08/17/2021 11:59 PM

Generate Subscribe

\* Reports with this symbol are unable to be run for multiple locations. If more than one location is selected only the first will be considered.

\* The calendar time selector has been updated to reflect conventional time frames versus the previous business day settings. Business day time frames can be achieved through the use of the quick action buttons or by simply entering the time frames manually.

Activity Summary 01/01/2021 04:00AM - 08/18/2021 03:59AM

Download Print

Totals

Business Trends	
Headcount	442
Avg. Head	\$149.28
Open Tickets	69
Closed Tickets	292

Show More

Gross Sales by Revenue Class	
Beer	\$10087.43
Credit Card Surcharge	\$906.13
Food	\$15108.46
Liquor	\$12090.94
Non-Alc Bev	\$10102.46

Show More

## Reports:

- Currently available LBM report creator shown on this page
- This page will differ by vertical, hospitality & retail
-

A Web Page

https://

Logo

Select Location

Quick Links: [Menu](#)

Home Transactions Reports **Virtual Terminal** Configuration Marketing Capital Applications Maintenance Settings

### Virtual Terminal

08/15/2021 - 08/17/2021 9876 [Generate](#) [Refund](#) [New Sale](#)

Invoice	Total	Date	Auth #	Tip	Card #	Name	Type	Action
No Records To Display								

### Virtual Terminal:

- Currently available LBM Virtual Terminal application shown on this page
- This page will be consistent for all verticals

A Web Page

https://

Logo

Select Location

Home Transactions Reports Virtual Terminal Configuration Marketing Capital Applications Maintenance Settings

Quick Links: Menu

[Locations](#) [Employees](#) [Menu Tables](#) [Payments](#) [Accounting](#)

### Manage Employees

Employees Jobs

All status Search by Employee [Add Employee](#)

Name	Jobs	Status	Created at
Adam S	Bartender, Manager, Order Taker	Active	07/15/2021
Ana Vazarian 0001	CounterSvc Cashier	Active	01/15/2019
Andrew	Barback, Bartender, Busser, CounterSvc Cashier, Host/Hostess, LEAD Cashier, Manager, Owner, Pool Bar Bartender, POS Tech Support, Prep...	Active	10/09/2018
Betty Ba	Bartender, Busser, Head Bartender, Server	Active	08/13/2018
Billy Bartender 0104	Pool Bar Bartender	Active	08/13/2018
Bobby Barback 0005	Barback, Delivery Cashier, LEAD Cashier, Owner	Active	08/13/2018
BRAD	Barback, Bartender, Busser, CounterSvc Cashier, Delivery Cashier, DriveThru, Head Bartender, Host/Hostess, LEAD Cashier, Manager, Order Ta...	Active	06/25/2021
Brian	Bartender, Server, Shift Manager	Active	08/09/2018
Brian S.	Barback, Bartender, Busser, CounterSvc Cashier, Delivery Cashier, DriveThru, Head Bartender, Host/Hostess, LEAD Cashier, Manager, Order Ta...	Active	03/19/2021
Bruce Hildreth	Bartender, CounterSvc Cashier, Prep Cook	Active	06/14/2018

10

1 2 3 7 >

## Configuration:

- POS Configuration page
- All configuration categories shown in secondary nav
- Existing LBM configuration pages utilized in this section
- This section dependent on vertical and POS product

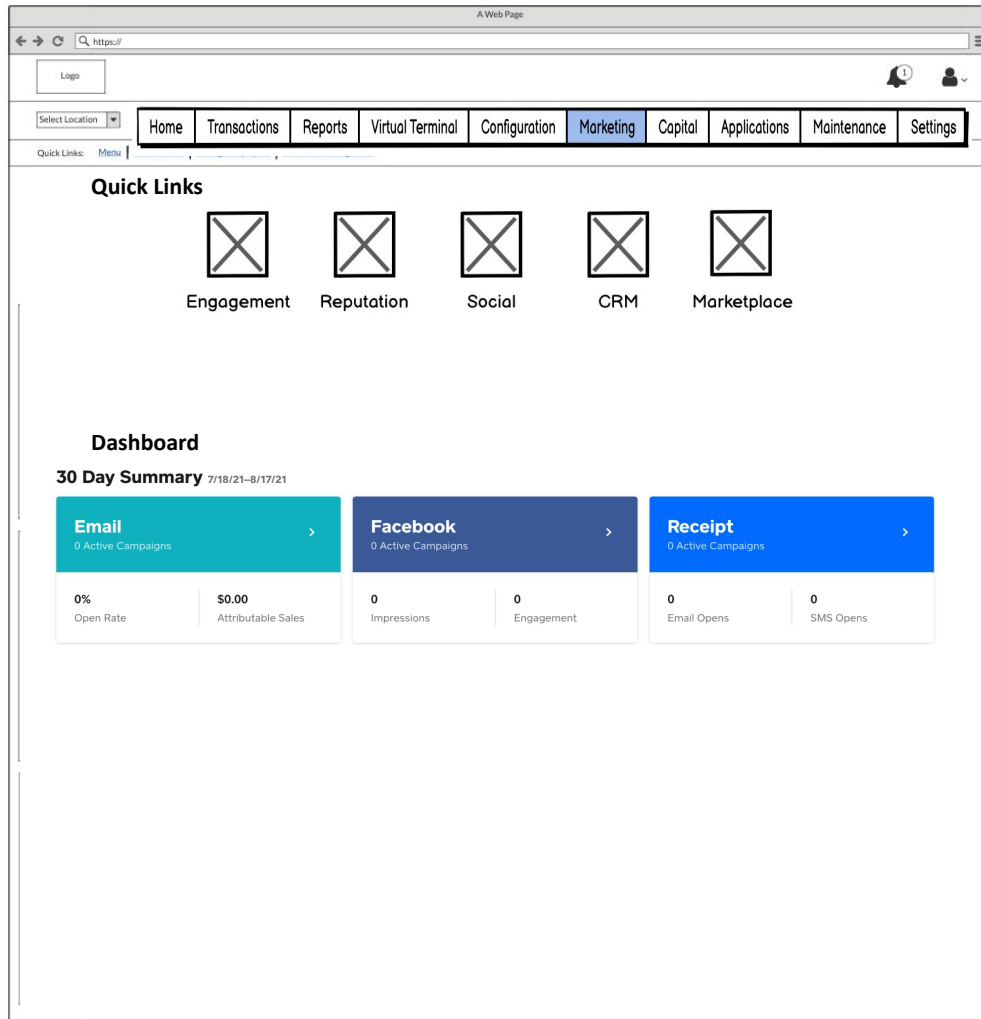

## Marketing:

- This page is placeholder only
- Intention is consolidation of all marketing capabilities on single page with quick dashboard view of activity and performance
- Plan to hire a Marketing product lead to own these capabilities and roadmap
- This page will be consistent for all verticals

A Web Page

← → 🔍 https://

Logo

Select Location ▾

Quick Links: [Menu](#) | [Home](#) | [Transactions](#) | [Reports](#) | [Virtual Terminal](#) | [Configuration](#) | [Marketing](#) | [Capital](#) | [Applications](#) | [Maintenance](#) | [Settings](#)

### Loan Page Title

**Get fast access to the funds you need to see your business soar!**

**\$6,000.00**

Apply For Loan

Fixed Fee: \$300 • Withheld Client Payments: 17%

All loans are issued by Blue Ridge Bank, National Association, located in Lynch VA. The individual authorized to act on behalf of the business must be a U.S. citizen or permanent resident and at least 18 years old. Valid U.S. bank account and Social Security number or individual Taxpayer Identification Number are required. Actual fee depends upon payment card processing history, loan amount and other eligibility factors. Loan eligibility not guaranteed. All loans subject to credit approval.



**Selling Point #1 Title is here**

Lorem ipsum dolor sit amet, consectetur adipiscing elit, sed do eiusmod tempor incididunt ut labore et dolore magna aliqua. Ut enim ad minim veniam, quis nostrud exercitation ullamco laboris nisi ut aliquip ex ea commodo consequat.

## Capital:

- Shift4 Capital Loan Opt-In page
- This page not yet available
- Latest design approach available [here](#)
- This page will be consistent for all verticals



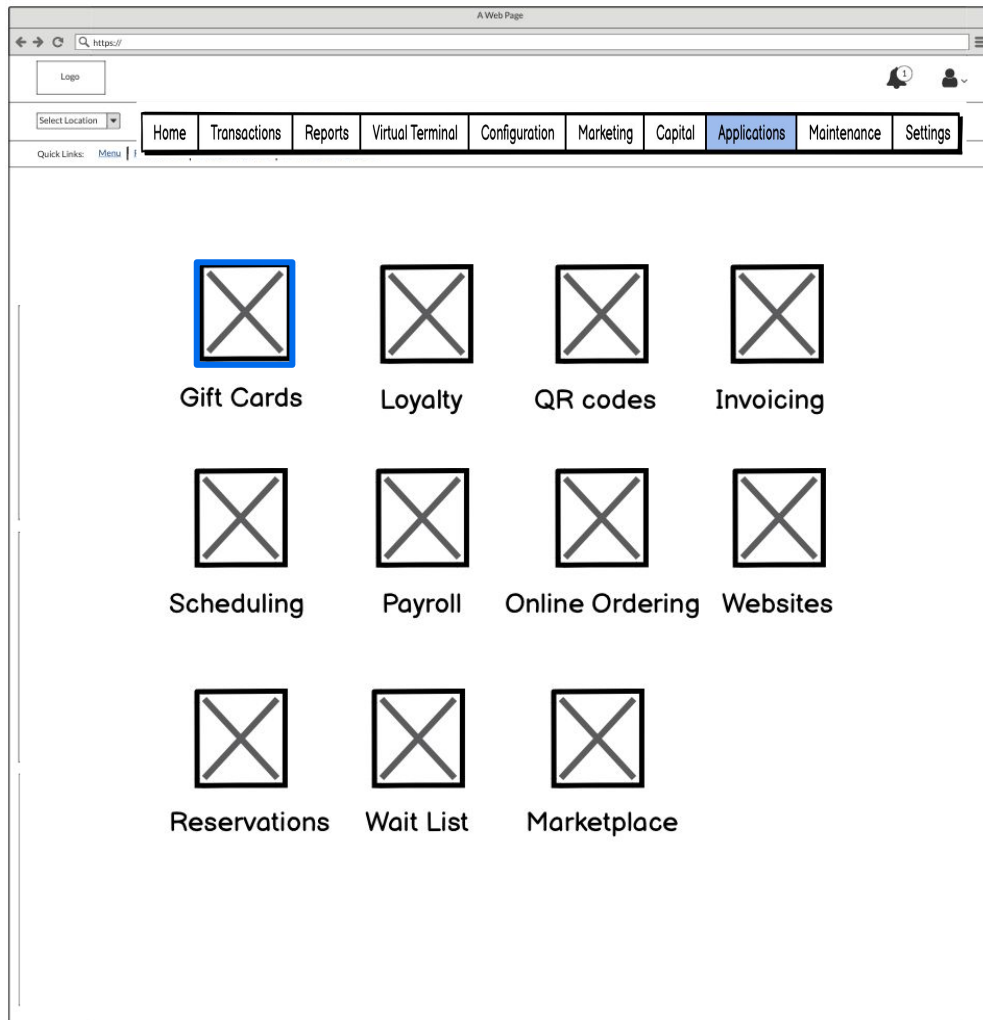

## Applications (1 of 2):

- Placeholder page
- Showcase all add-on products, collection of both Shift4 & Partner/whitelabel products
- Each product will have an individual product page to define value/capabilities and CTA to configure and launch the product (see next slide)
- Buttons will be represented similar to this:

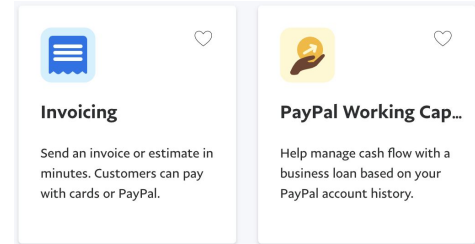

- This page will vary by vertical

A Web Page

← → 🔍 https://

Logo

Select Location ▾

Quick Links: [Menu](#)

[Home](#) [Transactions](#) [Reports](#) [Virtual Terminal](#) [Configuration](#) [Marketing](#) [Capital](#) [Applications](#) [Maintenance](#) [Settings](#)

## Gift Cards

**Create Gift Cards for Your Restaurant**

Easily create physical and digital gift cards with pre-set amounts to attract more customers to your restaurant.

[Create Gift Cards](#)





**Sell Gift Cards Online in Minutes**

Simply upload your logo, choose your brand colors, and set up gift card amounts to start selling them right away from an easy-to-use, custom website. Get paid fast through Shift4 Payments and grow your audience.

**Convenient for Your Customers**

Customers can choose physical gift cards or opt to receive digital gift cards via email that can be printed out or redeemed on their mobile device. Gift cards attract new customers and bring your regulars back again and again!



## Applications (2 of 2):

- Gift Card product example

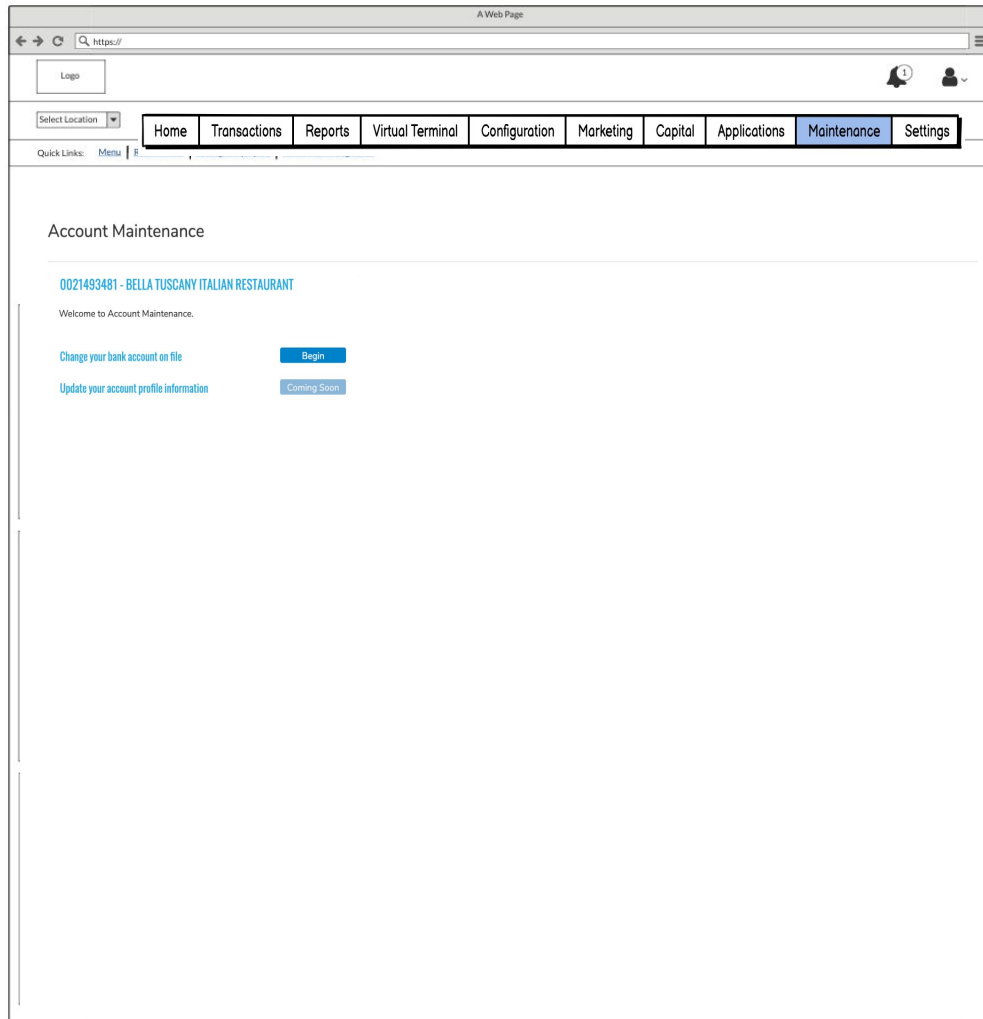

## Maintenance:

- Currently available LBM Account Maintenance page
- This page will be consistent for all verticals

A Web Page

← → 🔍 https://

Logo

Select Location ▾

Quick Links: Menu

Home Transactions Reports Virtual Terminal Configuration Marketing Capital Applications Maintenance **Settings**

### Profile & Settings

[Account](#) [Settings](#) [Users](#) [Locations](#) [Subscriptions](#) [Two-Factor Authentication](#)

#### Account

Profile

First Name  Last Name

E-Mail

Password

Current Password

New Password

Confirm New Password

[Update Account](#)

## Settings:

- Currently available LBM Profile & Settings shown on this page
- This page will be consistent for all verticals